

SPECIAL APPLICATION PROFILE

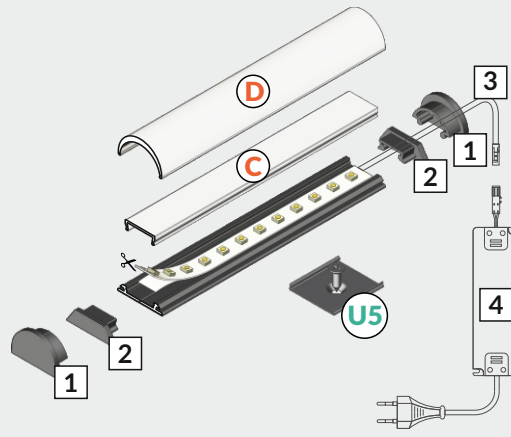

pliers

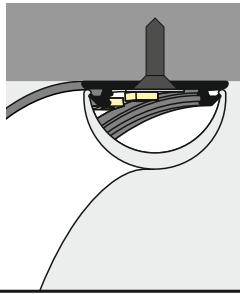
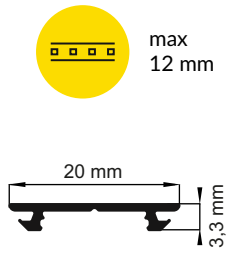

hacksaw



soldering iron



solder



drill



screwdriver

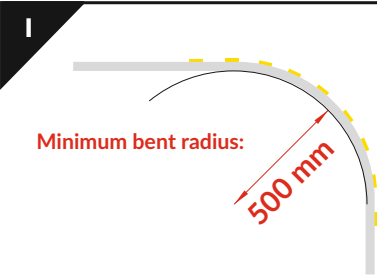

**Note!** When bending to the outside (picture on the left), the needed length of the cover is greater than the length of the profile.

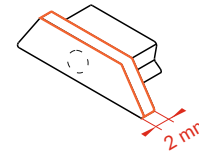
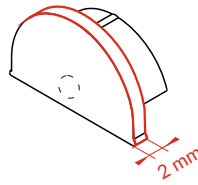

**Note!** Endings with marked space to bore a hole.

**Note!** Ending thickness increases the length of the luminaire

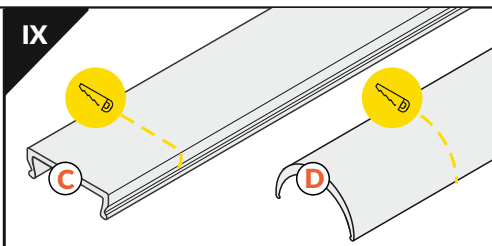
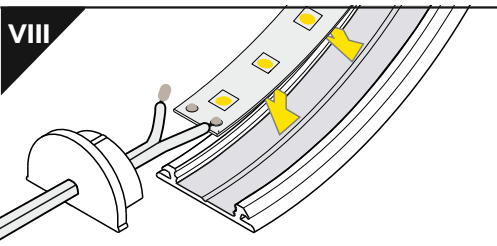
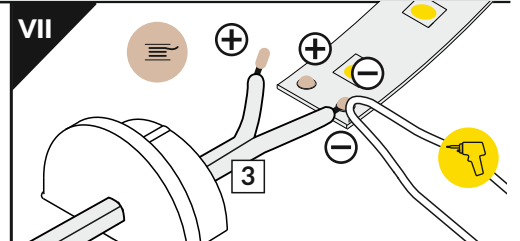
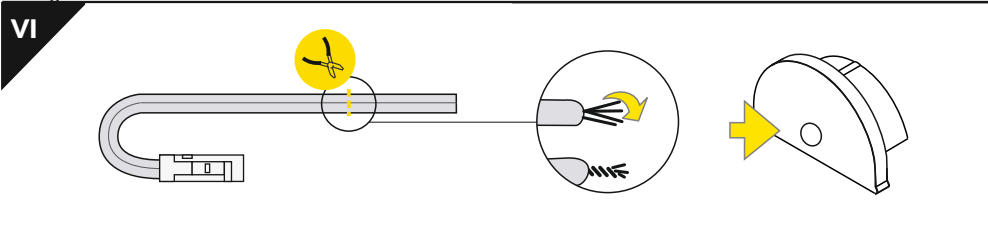
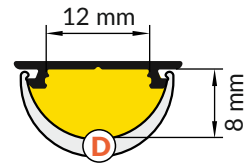
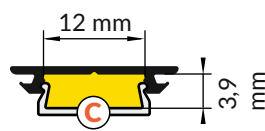
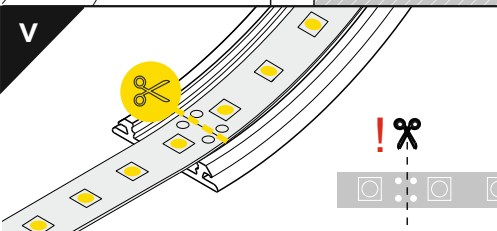
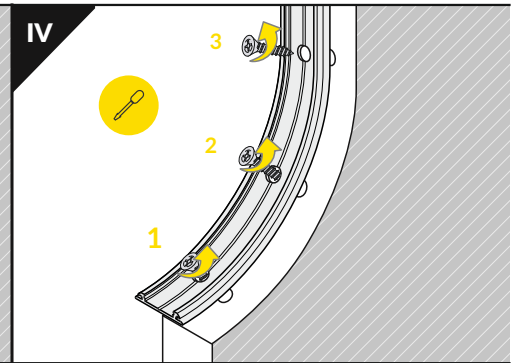
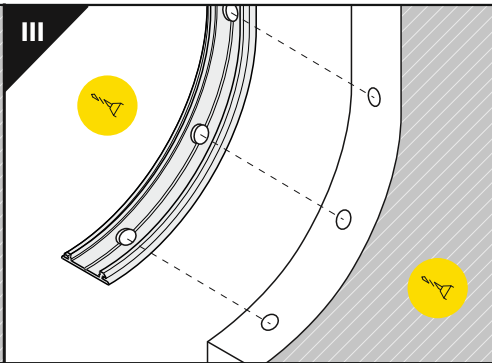
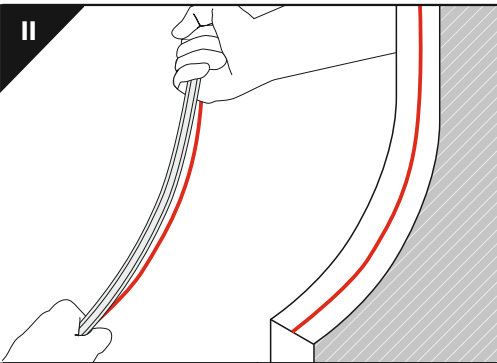

VI

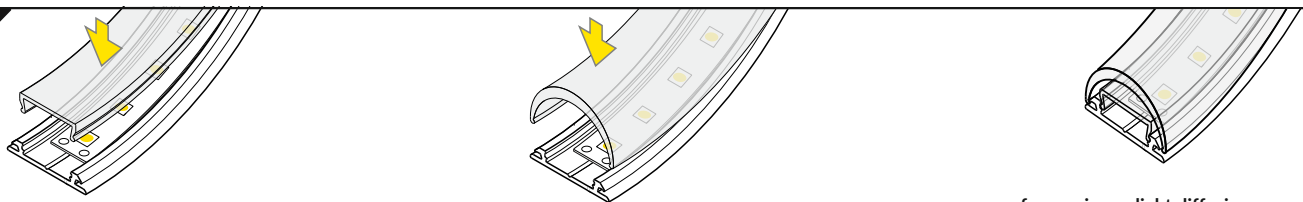

C click cover

D slide cover

C + D for maximum light diffusion

### VII MOUNTING

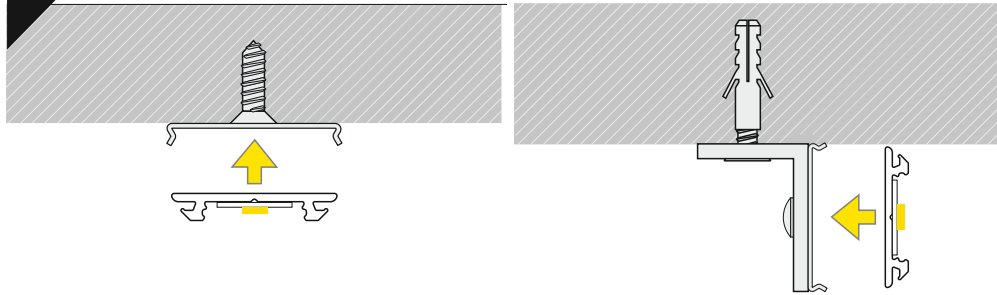

50 V 1500

sling + LED power supply housing

#### I

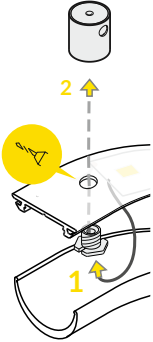

#### II

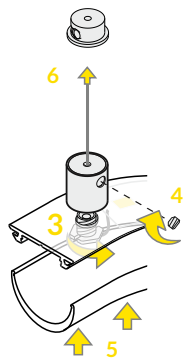

#### III

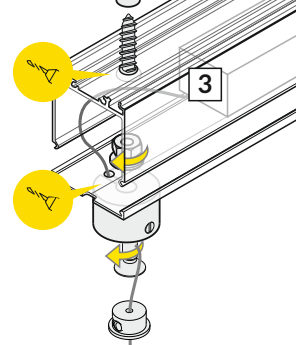
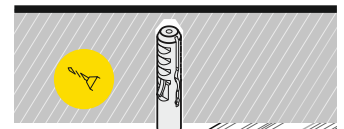
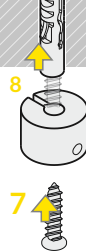

50 V 1500

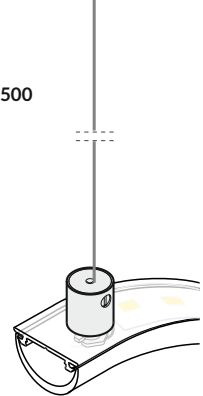

#### IV

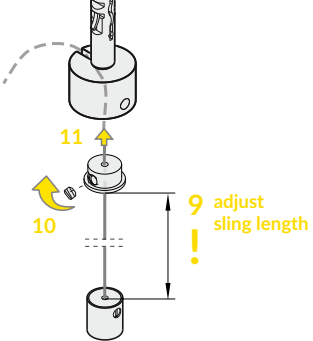

#### V

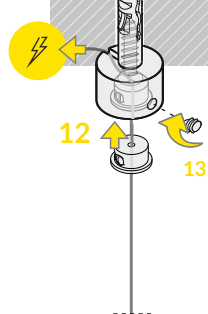

IX

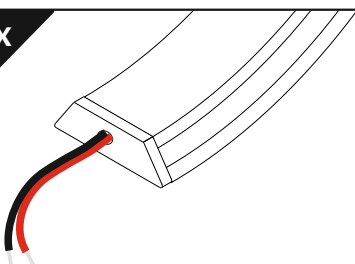

12V/24V

230V

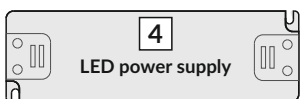

### ACCESSORIES

- power switches
- controller + remote
- movement sensors