

Barra sottile luminosa SKYLINE

Cod. AV6269XIAA



Direct Lighting



Indirect Lighting



Wall Washer Lighting

Features

1. Designer's favorite free style mounting bar of LEDstrip for various applications.
2. From the inspiration of the classic mathematical principle "Two points make a line", the light can be flexible flew across many 3D spaces.
3. Continuous linear lighting performance up to 20M[65.5ft.] run length.
4. Deluxe appearance in stainless steel with matt black color.
5. Field cuttable and free-cutting to be any desired length.
6. Simple usage and convenient installation operation.

Application

Direct lighting, indirect lighting and wall washer lighting for residential, retail, hospitality and architecture.

(In order to get a better lighting performance, it's recommend to have sufficient distance between mounting bar and luminous area. For indirect lighting illuminating to the ceiling is 400mm[15.7in.], for wall washer lighting glazing to the wall is 200mm[7.87in.]

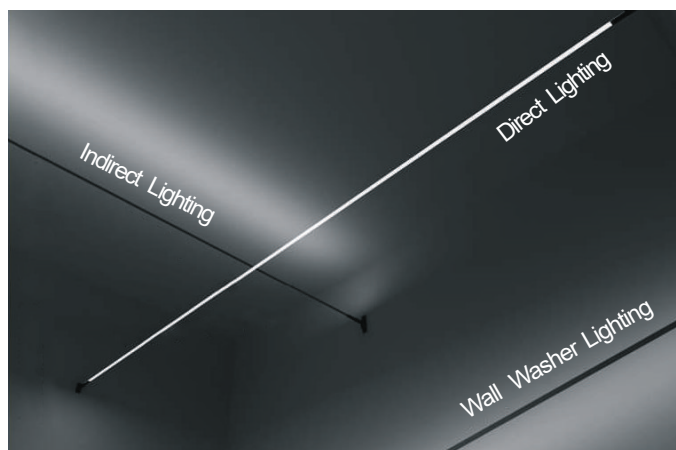

Barra sottile luminosa SKYLINE

Cod. AV6269XIAA

Diagram & Dimension

Recessed Mounting Version

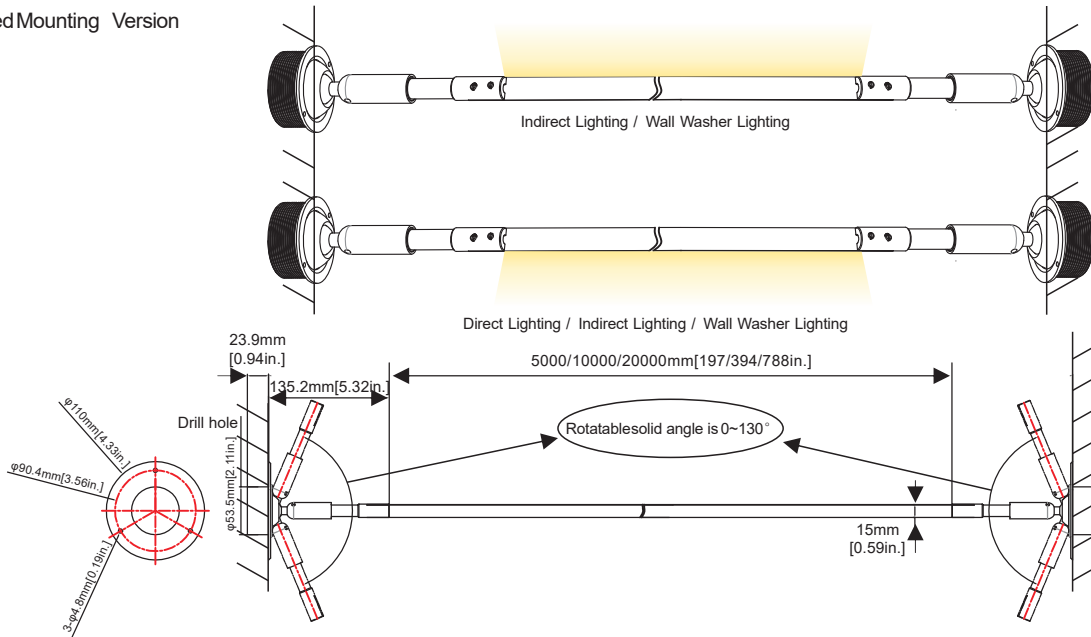

Surface Mounting Version

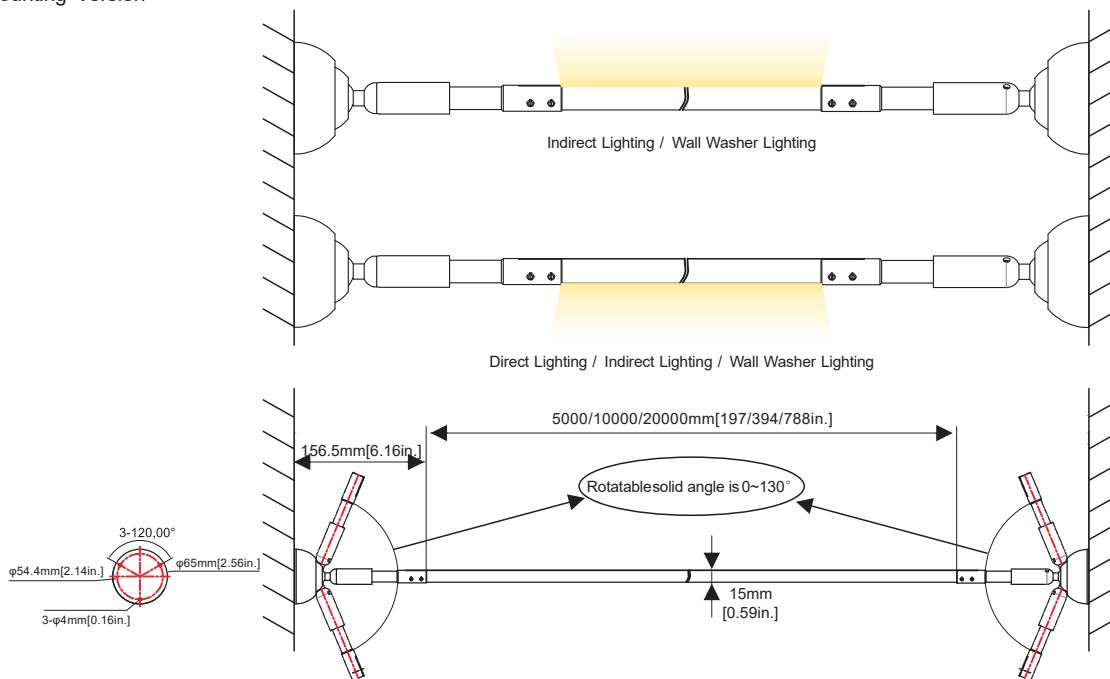

Free Cutting Mounting Bar

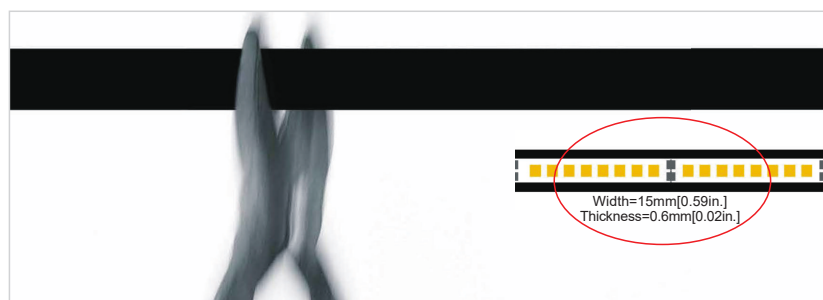

Barra sottile luminosa SKYLINE

Cod. AV6269XIAA

User Instruction

Recessed Mounting Version

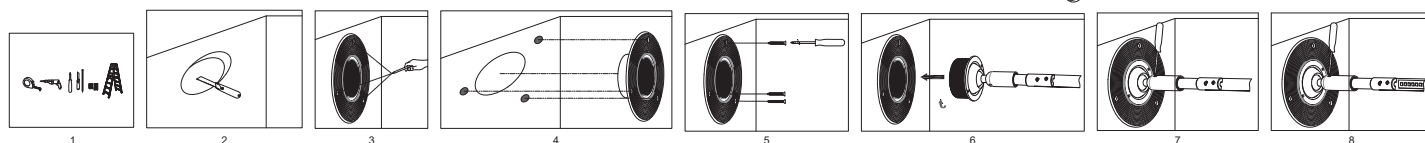
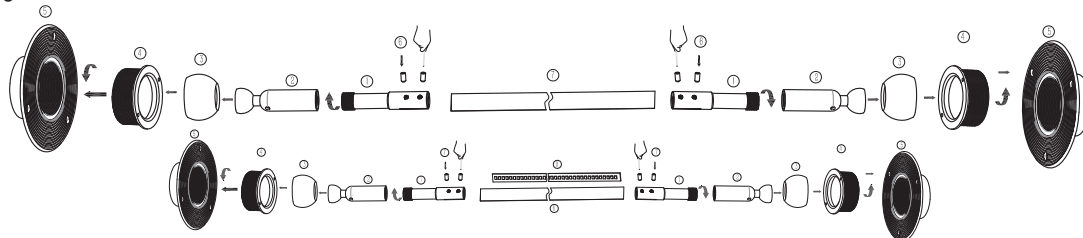

1. Prepare some tools as required.
2. Drill a hole with diameter in 60~65mm[2.36~2.56in.] on the mounting surface.
3. Position the hole on the mounting surface with the base⑤.
4. Put the base to the recessed hole.
5. Fix the base⑤ on the mounting surface with screw.
6. Fix the bar kit (pre-assembled as below) into the base⑤.
 - a. Fix the pole① to the pole②.
 - b. Fix the pole② to the spherical base③.
 - c. Fix the spherical base③ (pre-cut as required) to the base④.
 - d. Fix the bar⑥ to the pole① with screw⑦.
7. Adjust the bar⑥ position as required and strain the bar kit with screw driver.
8. Stick the LED strip⑧ (pre-cut as required) onto the bar and connect to the power supply.

Surface Mounting Version

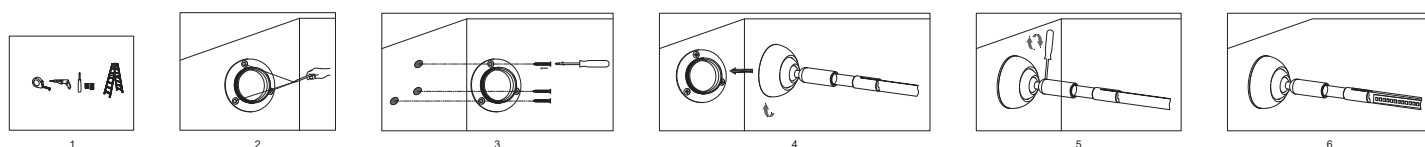
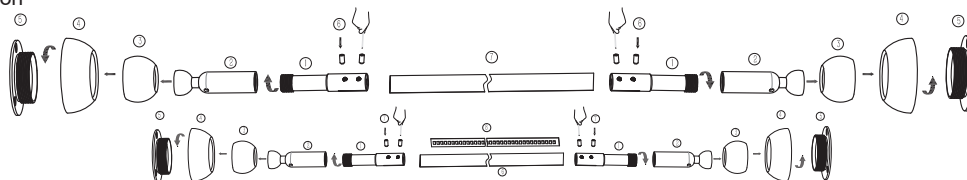

1. Prepare some tools as required.
2. Position the hole on the mounting surface with the base⑤.
3. Fix the base⑤ on the mounting surface with screw.
4. Fix the bar kit (pre-assembled as below) into the base⑤.
 - a. Fix the pole① to the pole②.
 - b. Fix the pole② to the spherical base③.
 - c. Fix the spherical base③ to the spherical base④.
 - d. Fix the bar⑥ (pre-cut as required) to the pole① with screw⑦.
5. Adjust the bar⑥ position as required and strain the bar kit with screw driver.
6. Stick the LED strip⑧(pre-cut as required) onto the bar and connect to the power supply.

