

ER17505

Electrical characteristics

Typical values relative to cells stored for one year

Nominal capacity (Discharged capacity at 0.5mA, +25°C, 2V cut off)	3600mAh
Nominal voltage	3.66V
Max.recommended continuous current Discharged to 2V at +25°C permitting 50% of the Nominal capacity to be achieved	100mA
Max. Pulse current 200mA, 0,1 second pulses every 2 minutes, drained with 50%, 2mA at 25°C from undischarged cells with 20mA base current, yield voltage readings above 2.7V, the value may vary according to the pulse characteristics, the temperature and the cell's previous history.	200mA
Storage	Max 30°C
Operating temperature range	-55~+85°C
Weight	≈27g

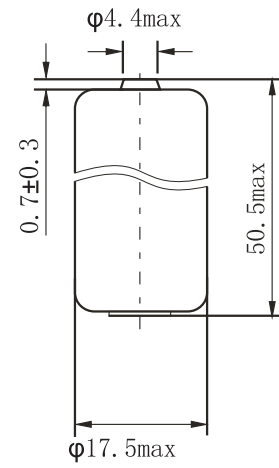

Dimensions in mm

Available Terminations

- /P Axial pin
- /T/PT2 Radial Pin
- /PT/TP Polarized Tab

Special terminal can be made according to customer's requirement

Discharge characteristics at 25°C

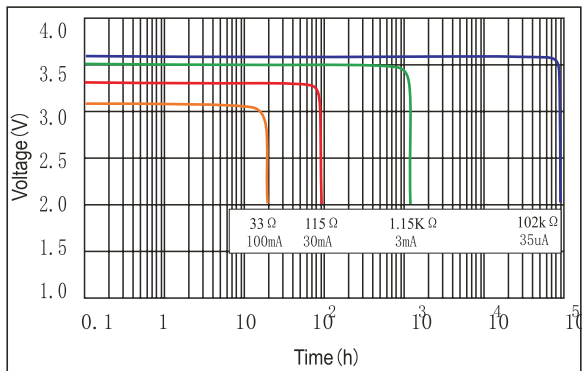

Voltage vs. Current an Temperature

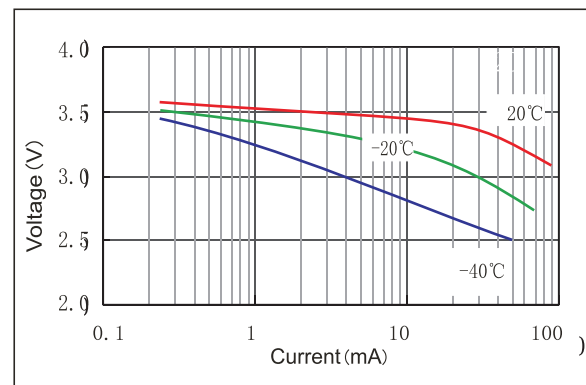

Capacity vs. current and Temperature

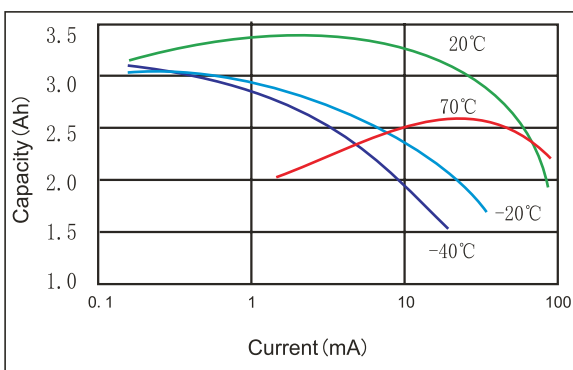

Storage Characteristics

