

# ER2450

TIRE PRESSURE MONITORING SYSTEM

## Electrical characteristics

Typical values relative to cells stored for one year

Nominal capacity (Discharged capacity at 0.5mA, +25°C, 2V cut off)	500mAh
Nominal voltage	3.66V
Max.recommended continuous current (Discharged to 2V at +25°C permitting 50% of the Nominal capacity to be achieved)	8mA
Max. Pulse capability 20mA/0.1s pulse, drained every 2 minutes at 25°C from 1mA mid-charged cells with 20µA base current, yield voltage readings above 2.7V, the readings may vary according to the pulse characteristics, the temperature, and the cells's previous history.	20mA
Storage	Max 30°C
Operating temperature range	-55~+125°C
Weight	≈9g

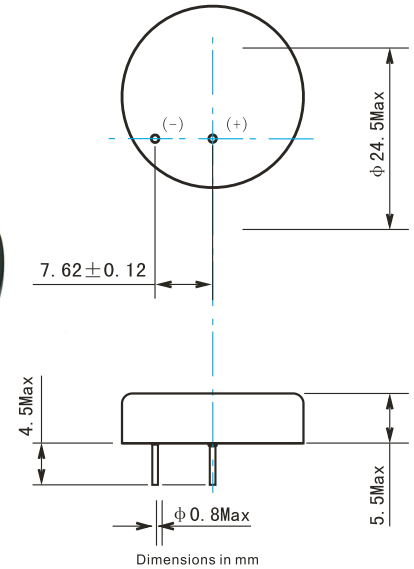

Available Terminations

- /P Axial pin
- /T/PT2 Radial Pin
- /PT/TP Polarized Tab

Special terminal can be made according to customer's requirement

## Discharge characteristics at 25°C

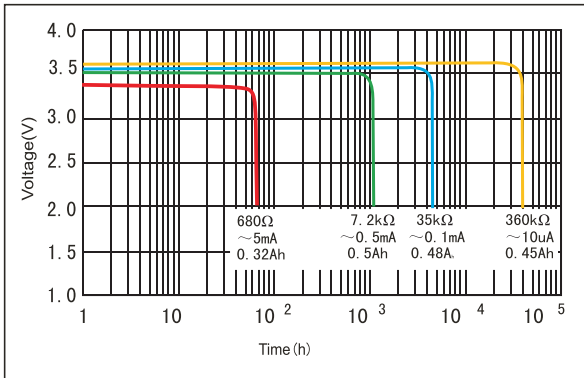

## Voltage vs. Current an Temperature

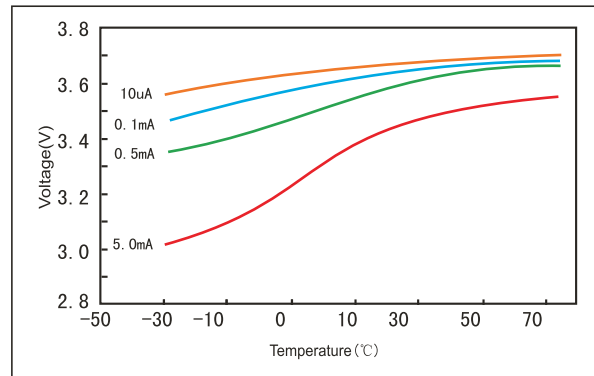

## Capacity vs. current and Temperature

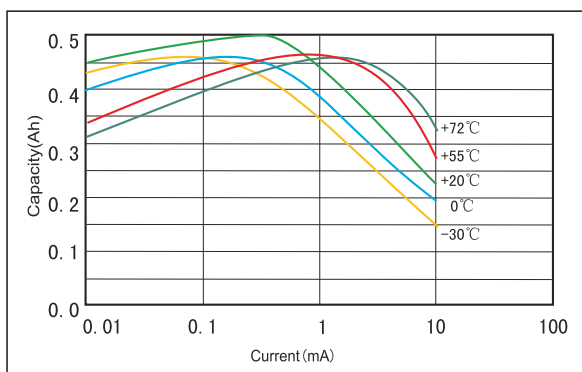

## Storage Characteristics

